



jordan fishwick

ALTRINCHAM
Brown Street



Brown Street, Altrincham, WA14 2ET

Asking Price £265,000



The Property

A superbly located first floor apartment within a purpose built development positioned on one of the popular 'B Streets', which is ideal for a first time buyers and only a short walk into both Hale Village and Altrincham Town Centre, therefore excellently placed for all amenities and local transport links which connect to Manchester City Centre.

The property comprises; Communal Entrance. Communal Hall. Entrance Hall. Bright Open Plan Kitchen Living Area, Double Bedroom. Bathroom and Large Store. The property also boasts under croft parking available subject to successful application of permit

The property is currently under shared ownership but can be purchased in full.

Directions

WA14 2ET



Map data ©2025 Google

- Shared ownership or purchase putright
- Leasehold - 246 years remaining
- Ground Rent £0
- Service Charge £168.31 pcm
- Under croft parking available subject to permit application.
- Flexible shared ownership % available
- No chain
- Central location of Hale village
- Walking distance to Altrincham Town Centre
- Close to amenities and transport links

Postcode - WA14 2ET

EPC Rating - B

Floor Area - 516.00 sq ft

Local Authority - Trafford

Council Tax - B



GROUND FLOOR
516 sq.ft. (47.9 sq.m.) approx.

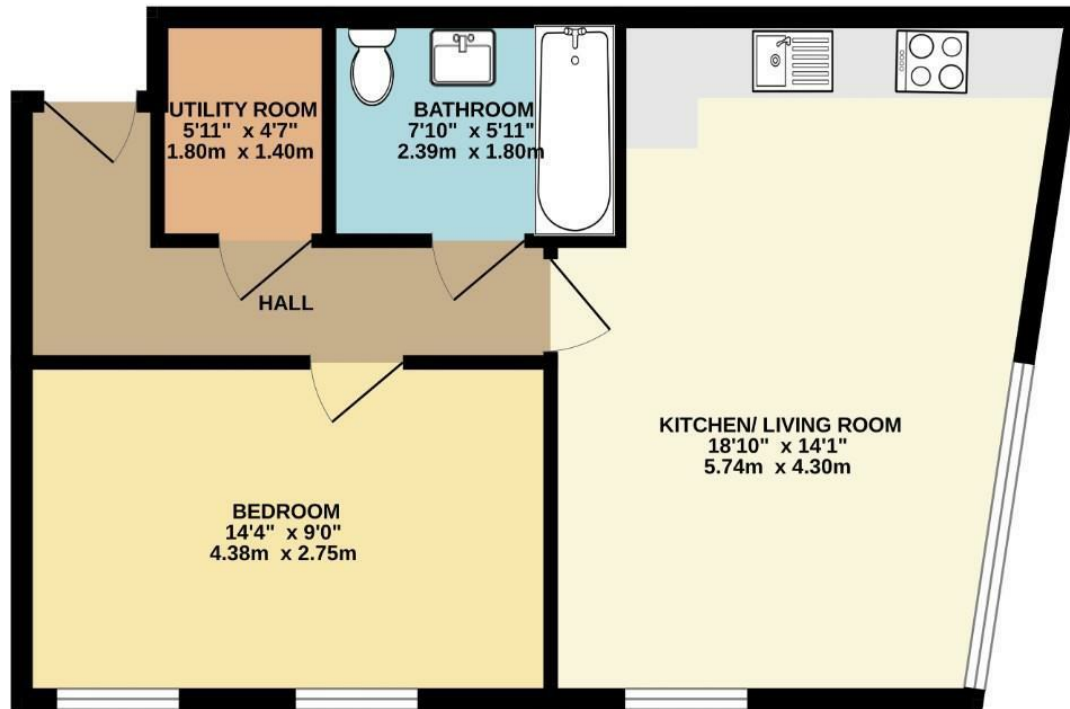

TOTAL FLOOR AREA: 516 sq.ft. (47.9 sq.m.) approx.

Whilst every attempt has been made to ensure the accuracy of the floorplan contained here, measurements of doors, windows, rooms and any other items are approximate and no responsibility is taken for any error, omission or mis-statement. This plan is for illustrative purposes only and should be used as such by any prospective purchaser. The services, systems and appliances shown have not been tested and no guarantee as to their operability or efficiency can be given.
Made with Metropix ©2025



These particulars are believed to be accurate but they are not guaranteed and do not form a contract. Neither Jordan Fishwick nor the vendor or lessor accept any responsibility in respect of these particulars, which are not intended to be statements or representations of fact and any intending purchaser or lessee must satisfy himself by inspection or otherwise as to the correctness of each of the statements contained in these particulars. Any floorplans on this brochure are for illustrative purposes only and are not necessarily to scale.

Offices at: Chorlton, Didsbury, Disley, Hale, Glossop, Macclesfield, Manchester Deansgate, Manchester Whitworth Street, New Mills, Sale, Wilmslow and Withington

0161 929 9797

hale@jordanfishwick.co.uk
www.jordanfishwick.co.uk